

## Push Trolley type 20

---

### Product information



Low-built block trolley for hanging e.g. chain blocks and wire hoists. The trolley can be supplied with a load of 0.5 tons up to 10 tons. The trolley has corner protection which prevents the trolley from detaching from the beam and ball bearing wheels. It is easily adjustable by the left- and right-handed carrier bracket and fits most brands of hoists.

[... Read more](#)

---

**Marking:** CE-marked, WLL, name plate and beam width

**Temperature range:** -10°C up to +50°C

**Finish:** Powdercoated steel sides

## Push Trolley type 20

### Blueprint

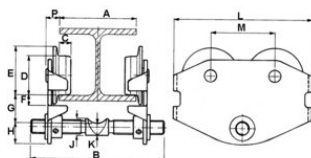

### Lifting table

Part code	WLL ton	Beam width mm	Model	Minimum radius mm	A mm	B mm	C mm	D, mm	E mm	F mm	G, mm	H, mm	J mm	K mm	L mm	Mmm mm	Pmm mm	Weight kg
502300051600420	0.5	46-160	20123A	1,000	46-160	208	18	62	77	18	45	33	25	19	216	100	24	6
502300052800420	0.5	161-280	20124A	1,000	161-280	208	18	62	77	18	45	33	25	19	216	100	24	6.4
502300101610420	1	50-160	20143A	1,250	50-160	212	20	70	85	20	51	40	32	24	264	130	26	9.4
502300102800420	1	161-280	20144A	1,250	161-280	212	20	70	85	20	51	40	32	24	264	130	26	10.7
502300203000420	2	181-300	20164A	1,800	181-300	248	24	100	118	24	63	51	40	32	345	165	30	21
502300301800420	3	74-180	20173A	2,200	74-180	262	28	114	137	28	78	57	46	35	384	180	35	31.5
502300303000420	3	181-300	20174A	2,200	181-300	262	28	114	137	28	78	57	46	35	384	180	35	34
502300501800420	5	82-180	20193A	2,500	82-180	270	34	140	165	34	92	64	56	42	455	215	40	55
502300503000420	5	181-300	20194A	2,500	181-300	270	34	140	165	34	92	64	56	42	455	215	40	58