

## Eye Grab Hook X-079

### Product information



- At least 25% greater WLL than traditional Grade 8 products.
- Proof Load tested at 2.5 times the WLL with certification for each batch manufactured.
- Fatigue rated to 20,000 cycles at 1.5 times the WLL.
- Magnaflux crack detection is performed 100% on each batch.
- No reduction in WLL when shortening chain.

... [Read more](#)

**Material:** Quenched and Tempered Alloy Steel

**Marking:** According to standard, CE-marked

**Temperature range:** -40°C up to +200°C (without reduction in WLL).

**Finish:** Blue painted.

**Standard:** EN 1677-1

**Safety factor:** 4:1

**Grade:** 10

## Eye Grab Hook X-079

### Blueprint

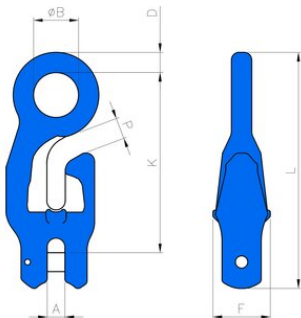

### Lifting table

Part code	Chain diameter mm	WLL ton	EWL mm	A mm	B mm	D mm	F mm	K mm	L mm	P mm	Weight kg
402300140760	5-6	1.4	76	8	18	9	24	76	99	12	0.24
402300250760	7-8	2.5	102	10	24	13	32	102	134	12	0.54
402300400760	10	4	125	12	31	14	40	125	163	15	1.03
402300670760	13	6.7	158	16	37	18	51	158	208	20	2.18
402301000760	16	10	202	19	48	24	64	202	264	21	4.39