

Stainless Fork Terminal

Product information

Fork terminals are amongst the most commonly used wire end fittings. These terminals are to be swaged on the steel wire ropes with special swage equipment.

In use, they are normally attached to pre drilled anchor plates or steel constructions. Also used in combination with toggles, eyes or U-bolts.

... [Read more](#)



Material: Stainless steel AISI 316.

Marking: Logo, wire size and swage depth.

Temperature range: -50°C to +100°C and briefly up to +200°C

Finish: Polished.

Note: Small fork head design is square - from Ø 19 mm pin and up the design is rounded,

Warning: Do not apply to the cable yourself without using suitable swaging equipment.

Stainless Fork Terminal

Blueprint

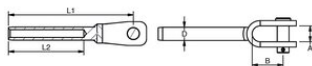

Lifting table

Part code	Rope diameter mm	Pin diameter mm	MBL ton	A mm	B mm	D mm	L1 mm	L2 mm	Weight kg/100pc
1207100502	2	5	0.8	7,5	12	5,5	58	32	2
1207100503	3	5	0.8	7,5	12	6,4	67	38	2.3
1207100532	3.2	5	0.8	7.5	12	6.35	67	38	2.3
1207100604	4	6	1.5	9,5	13	7,5	73	45	3.4
1207100805	5	8	2.4	11	15	9,0	87	51	5.5
1207109506	6	9.5	3.8	12	19	12,6	104	64	11.3
1207101207	7	12	6.5	14	25	14,2	119	70	18.1
1207101608	8	16	8.5	17	33	16,0	145	83	25.5
1207101610	10	16	9.4	17	33	17,8	149	89	36.6
1207101912	12	19	11.2	24	48	20,0	189	105	66
1207102214	14	22	15	30	57	25,0	232	140	112.7