

Container Lifting Lug CLT Grade 8

Product information



Container lifting lug set for lifting of standard containers in the corner fittings on top. Only for vertical lifting slings. A set contains 4 lugs and are to be used together with a lifting beam. The lugs suits standard ISO corner boxes.

Features: Provided with barrier which locks in the corner fittings after the lug is rotated 90° which prevent the lug to unhook. No part of the lug is outside the containers sides.

... [Read more](#)

Material: Alloy steel.

Marking: CE-marked

Temperature range: -40°C up to +100°C

Warning: Do not use with 4-leg slings. Only for straight lifting.

Safety factor: 4:1

Grade: 8

Container Lifting Lug CLT Grade 8

Blueprint

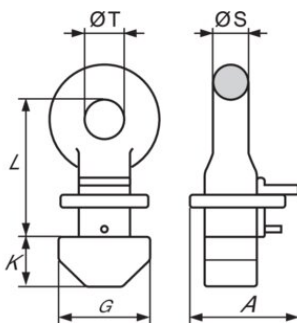

Lifting table

| Part code | Code | WLL ton | EWL mm | A mm | G mm | K mm | L mm | S mm | T mm | Weight kg |
|-----------|--------|---------|--------|------|------|------|------|------|------|-----------|
| 4298CLT56 | CLT-56 | 56 | 160 | 123 | 101 | 57 | 160 | 39 | 45 | 32 |