

Lift Fitting LB-1

Product information



With keyhole for lifting all types of containers with lifting shanks. Connecting to the chain sling with a connect link for 13 mm chain, (connecting link for 10 mm chain can be used on smaller loads).

Design: Cutted in sheet metal and bent.

Proof: 2 x WLL

[... Read more](#)

Material: Sheet metal from high-tensile construction steel.

Marking: LB-1.

Finish: Electro galvanized.

Lift Fitting LB-1

Blueprint

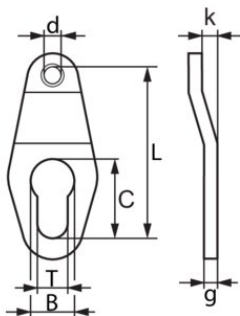

Lifting table

Part code	Code	WLL ton	EWL mm	Model	B mm	C mm	d mm	g mm	k mm	L mm	T mm	Weight kg
401500420130	LB-1	4.2	235	Straight	65	110	25	15	23	235	45	2.2