

Double Pallet Fork Type DP

Product information



CERTEX

Self-balancing — fixed and adjustable forks

General: For simultaneous lifting of two pallets. Double pallet forks are primarily used in stevedoring, but can also be used in other applications where large quantities of palletized goods are handled.

Design: Thanks to the spring-loaded lifting eye, the pallet fork is self-balancing, which means that the forks always remain horizontal, regardless of whether the pallet fork is empty or not. Please note the minimum load specified in the table. Concealed spring and linkage.

6022-DP - Fixed forks, designed for handling of two special 1200 x 1200 mm pallets.

6030-DP - Adjustable forks designed for handling of two standard pallets from the long side.

6032-DP - Adjustable forks designed for handling of two special 1000 x 1000 mm or 1200 x 1000 mm pallets from the long side.

Proof: Batch proof 2 x max last.

... [Read more](#)

Material: Hollow-beam and plate of high-strength structural steel.

Marking: Minimum load, Maximum load and CE-markning.

Finish: Yellow painted.

Double Pallet Fork Type DP

Blueprint

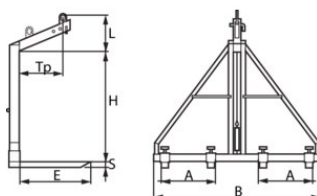

Lifting table

Part code	Code	WLL	Height m	Min. load kg	A mm	B mm	E mm	H, mm	L mm	S mm	Weight kg
62016030DP	6030-DP	3	1.5	300	840-220	1,900	800	1,500	500	50	230
62016032DP	6032-DP	3	1.5	300	840-220	1,900	980	1,500	490	50	240
62016022DP	6022-DP	3.2	1.5	300	720	1,990	1,150	1,600	750	60	320