

Clevis Sling Hook Pewag KHSWP

Product information



The forged safety catch locks into the tip of the hook, thereby providing excellent protection against lateral shifts. The safety catch mechanism and the clevis load pins are available as spare parts sets and easy and quick to exchange by a competent person.

The forged control markings make it easy to determine discard criteria [... Read more](#)

Material: Alloy steel

Marking: According to standard, CE-marked, Pewag or PW, winner pro or 12, H16, batch code and type.

Temperature range: -60°C up to +300°C.

Finish: Light blue powdercoated.

Standard: EN 1677-2

Warning: Not to be heat-treated.

Safety factor: 4:1

Grade: 12

Clevis Sling Hook Pewag KHSWP

Blueprint

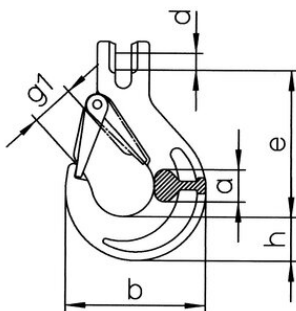

Lifting table

| Part code | Code | WLL ton | LC kN | EWL | a mm | b mm | d mm | e mm | g1mm mm | h mm | Weight kg |
|--------------|----------|---------|-------|-----|------|------|------|------|---------|------|-----------|
| 403300240030 | KHSWP 7 | 2.36 | 47 | 105 | 19 | 101 | 9 | 105 | 36 | 26 | 0.85 |
| 403300300030 | KHSWP 8 | 3 | 60 | 105 | 19 | 101 | 10 | 105 | 36 | 26 | 0.85 |
| 403300500030 | KHSWP 10 | 5 | 100 | 121 | 26 | 118 | 14 | 121 | 41 | 33 | 1.68 |
| 403300800030 | KHSWP 13 | 8 | 160 | 148 | 30 | 147 | 17 | 148 | 49 | 43 | 2.99 |
| 403301250030 | KHSWP 16 | 12.5 | - | 173 | 35 | 176 | 21 | 173 | 59 | 51 | 5.1 |